

The extra functions

Weidmüller can supply an extensive range of accessories for users of the SAK series of modular terminals. These help to provide the right solution for all manner of tasks, even those outside the scope of standard functions.

And of course, the accessories have to satisfy the same high standards of quality as the modular terminals themselves.

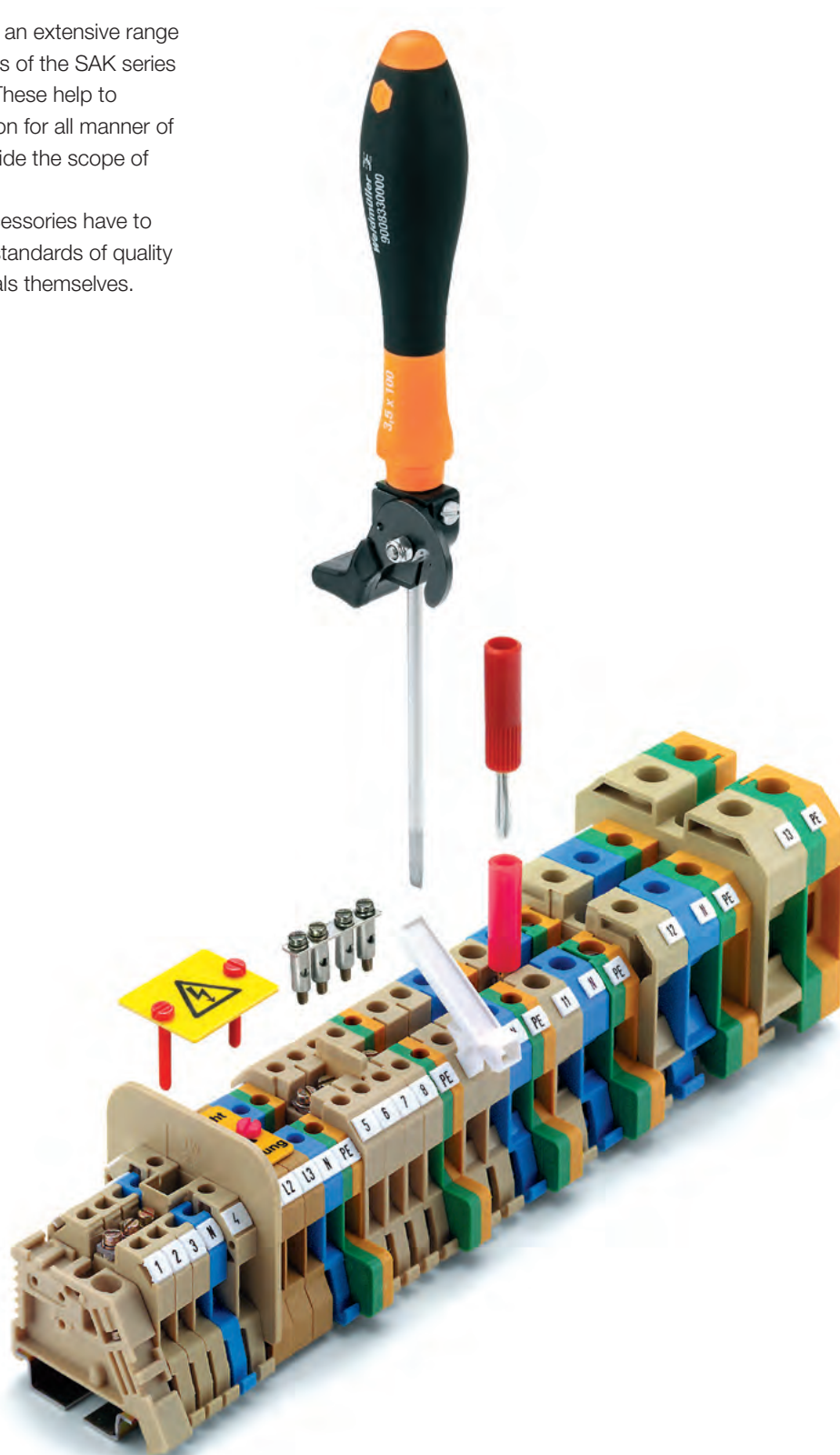

Visual separation – side covers

Page I.4



To guarantee protection against fingers coming into contact with live parts when working with modular terminals, open sides are blocked off with end cover plates and partition plates. But in addition, end cover plates and partition plates are available in various colours and so can be used to create a visual distinction between different circuits.

Colour coding options

Page I.6



Another helpful feature of the accessories for modular terminals with screw connections are the different colours available.

Potential distribution

Page I.8



Some 60% of all modular terminals are cross-connected. Weidmüller can supply a wide range of solutions.

Testing / Checking

Page I.14

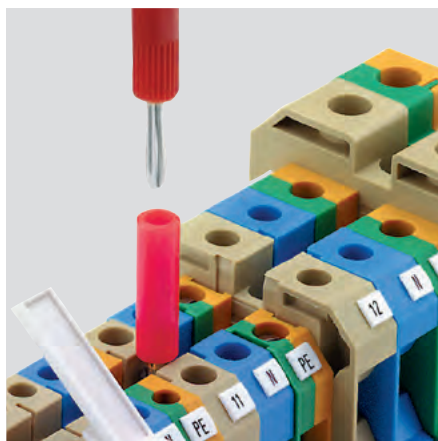

Weidmüller test plugs and sockets guarantee that the necessary tests can be carried out on the installation.

Protective covers

Page I.16



Electrical installations must be safe at all times. Therefore, Weidmüller can supply a large range of protective cover strips and plates, plus labelling systems.

Accessories for modular disconnect test terminals

Page I.20

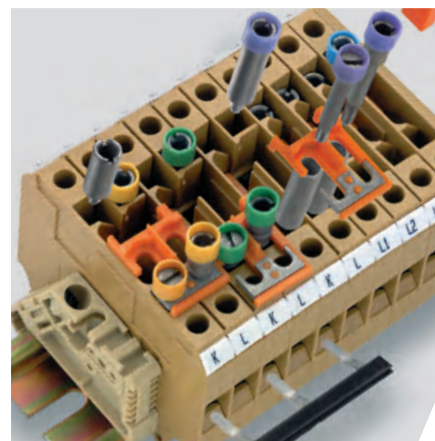

Special applications call for special solutions.

Visual separation – side covers

End cover plates



Apart from a few exceptions, the last terminal of a terminal strip must be covered with an AP end cover plate. End cover plates are also required within a terminal strip containing terminals of different sizes.

The overall dimensions of the end cover plates match the sizes of the associated terminals. The end cover plate is held in place by an end bracket.

AP end cover plates

| Type | | Order No. | for terminal type: |
|--------|-----|------------|---|
| AP | | 0150960000 | SAKD 2.5 N |
| AP 2.5 | KrG | 0279520000 | SAK 2.5 and TT |
| AP 2.5 | KrS | 0279530000 | SAK 2.5 L and LL |
| AP | KrG | 0117920000 | SAK 4, 6 N, 10, SAKC 4, NT 2, SLK 1, SAK 4 S and SS |
| AP 16 | KrG | 0271120000 | SAK 16 |
| AP 16 | PA | 0271160000 | |
| AP 35 | KrG | 0303620000 | SAK 35, 35 N |
| AP 35 | PA | 0303660000 | |
| AP 70 | KrG | 0340920000 | SAK 70 |
| AP 70 | PA | 0340960000 | |
| AP 95 | KrG | 0550920000 | SAK 95 |
| AP 2.5 | KrG | 0309220000 | SAK 2.5 L |
| AP | PA | 0438560000 | DK 4/380 Q |
| AP | KrG | 0266420000 | AST 1, 5 and 5 T |
| AP | KrG | 0298120000 | AST 3 and 4 |
| AP | PA | 0582560000 | AST 6, TOP 2.5 |
| AP | PA | 0483460000 | TOP 4 SF / FF |
| AP | KrG | 0294420000 | AKZ 4 |
| AP | PA | 0294460000 | AKZ 4 S and SS, AKZ 4, AKZ 4 L and LL, AKZ 4 T |
| AP | KrG | 0146720000 | SAKT 1, SAKC 10, SAKB 10, SAKS 7 |
| AP | KrG | 0329120000 | SAKT 2 |
| AP | PA | 0211360000 | SAKR, SAKR-L, SAKR-D |
| AP | KrG | 0134220000 | SAKA 10 |
| AP | KrG | 0191320000 | SAKS 1 and 3 |
| AP | PA | 0340560000 | AKZ 1.5, AKZ 1.5 T |
| AP | PA | 0329660000 | AKZ 1.5 W |
| AP | KrS | 0131730000 | SAKH 6 - 10 |

End clamp plates

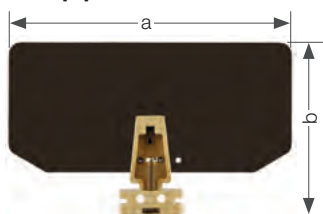

Dimensions (mm)

EP end clamp plates for SAKG

| Material | Thickness | a | b | Order No. | for terminal type: |
|-----------------------|-----------|-----|------|------------|--------------------|
| for mounting on TS 32 | | | | | |
| HP | 2 | 120 | 75.5 | 0205100000 | SAKG 28, 32 II, 70 |
| HP T* | 2 | 120 | 75.5 | 0205200000 | |
| HP | 2 | 160 | 90.5 | 0205300000 | SAKG 32 I + III, |
| HP T* | 2 | 160 | 90.5 | 0205400000 | 40, 46, 54 |
| for mounting on TS 35 | | | | | |
| HP | 2 | 120 | 75.5 | 0180500000 | SAKG 32 II, 70 |
| HP T* | 2 | 120 | 75.5 | 0180600000 | |
| HP | 2 | 160 | 90.5 | 0180700000 | SAKG 32 I + III, |
| HP T* | 2 | 160 | 90.5 | 0180800000 | 40, 46, 54 |

T* = suitable for tropical applications

End clamp plates

End clamp plate with mounting bracket EP ... /32

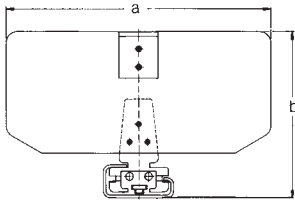

End clamp plate with mounting bracket EP ... /35

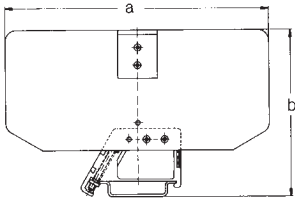

EP end clamp plates

| Type | a | b | Order No. | for terminal type: |
|---------|-----|------|------------|------------------------|
| EP 1 | 120 | 75.5 | 0271800000 | SAKG 28 and SAKG 70 |
| EP 2 | 160 | 90.5 | 0271900000 | SAKG 32, 40, 46 and 54 |
| EP 1/35 | 120 | 76.5 | 1381600000 | SAKG 32 and SAKG 70 |
| EP 2/35 | 160 | 91.5 | 0182000000 | SAKG 32, 40, 46 and 54 |

Strain relief clip

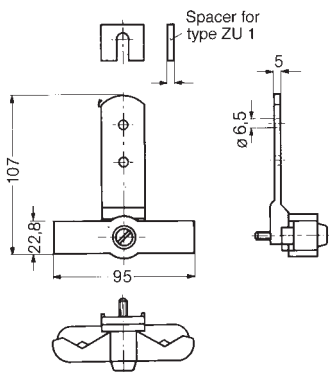

Strain relief clip for gripping cables up to 30 mm dia. Attach the strain relief clip between TS and mounting surface using the TS fixing screw. Fit the spacer to suit with the second fixing screw.

ZU 1

| Material | Qty. | Order No. |
|----------|------|------------|
| ZU 1 | 2 | 0240600000 |

Colour coding options

End cover plates



Protection against contact with live parts

Apart from a few exceptions, the last terminal of a terminal strip must be covered with an AP end cover plate. And end cover plates are also required within a terminal strip containing terminals of different sizes.

This guarantees protection against contact with live parts. The modular terminals are finger-touch safe (to DIN VDE 0106-100).

Visual separation

Coloured end cover plates are frequently used to create a visual distinction between different circuits

Guaranteeing the operating voltage

End cover plates can also be used to maintain the necessary clearance and creepage values and thus guarantee the operating voltage for the application. For example, if cross-connection sets are positioned directly adjacent one another.

Matching profiles

The overall dimensions of the end cover plates match the sizes of the associated terminals.

Installation

Spigots on the end cover plate enable it to be simply clipped into the corresponding modular terminal. The matching holes in the modular terminal ensure that the end cover plate is positioned exactly to match the profile of the terminal.

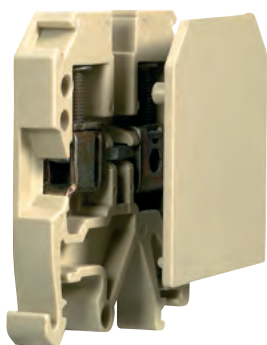

Visual separation – side covers

| Type | Colour | Qty. | Order No. | Type | Colour | Qty. | Order No. |
|-----------------------|------------|------|------------|----------------------|------------|------|------------|
| AP SAK4-10 DB | dark beige | 20 | 0105100000 | AP SAK35 KRG | dark beige | 10 | 0303620000 |
| AP SAK4-10 OR | orange | 20 | 0105160000 | AP AKZ2.5 BL | blue | 50 | 0697380000 |
| AP ASK1 OR | orange | 20 | 0105360000 | AP RSF2 KRG | dark beige | 10 | 0301420000 |
| AP DKT4 PA | beige | 20 | 0687560000 | AP SAK2.5 | beige | 20 | 0279560000 |
| AP AKZ2.5K | beige | 50 | 0697260000 | AP SAK2.5 KRG | dark beige | 20 | 0279520000 |
| AP AKZ2.5 | beige | 50 | 0697360000 | AP DLD2.5 BL | blue | 20 | 1317680000 |
| AP DKIT4 | beige | 20 | 0635060000 | AP AKZ1.5W | beige | 20 | 0329660000 |
| AP SAK4-10 RT | red | 20 | 0117900000 | AP SAKT2 KRG | dark beige | 20 | 0329120000 |
| AP SAK4-10 KRG/BL | blue | 20 | 0117970000 | AP AST3+4 KRG | dark beige | 20 | 0298120000 |
| AP SAK4-10 BL | blue | 20 | 0117980000 | AP DK4Q BL | blue | 20 | 1397180000 |
| AP SAKH 4EX | black | 20 | 0408730000 | AP SAK2.5L KRG | dark beige | 20 | 0309220000 |
| AP SAKH6-10 EP/SW | black | 20 | 0131700000 | AP RSF3 | beige | 10 | 0270460000 |
| AP DUSA4/35 | beige | 20 | 0401360000 | AP RSF1 KRG | dark beige | 10 | 0270420000 |
| AP SAKB/C/T BE | beige | 20 | 0146760000 | AP AST1+5 KRG | dark beige | 20 | 0266420000 |
| AP SAKD2.5N BL | blue | 20 | 0150980000 | AP AST1+5 | beige | 20 | 0266460000 |
| AP AKA2.5 KRG/BL | blue | 50 | 0162570000 | AP SAK16 KRG | dark beige | 20 | 0271120000 |
| AP SAK4-10 KRG/DB | dark beige | 20 | 0177600000 | AP SAKT4 KRG | dark beige | 20 | 0244920000 |
| AP SAKS1+3 KRG/DB | dark beige | 20 | 0191300000 | AP SAK16 | beige | 20 | 0271160000 |
| AP SAKR BE | beige | 20 | 0211360000 | AP SAK4-10 | beige | 20 | 0117960000 |
| AP 70 SAK70 KRG | dark beige | 10 | 0340920000 | AP SAK4-10 KRG | dark beige | 20 | 0117920000 |
| AP SAKR BL | blue | 20 | 0211380000 | AP SAK4-10 I | beige | 20 | 0117910000 |
| AP ASK1.5 | beige | 50 | 0340560000 | AP ASK1 DB | dark beige | 20 | 1753320000 |
| AP SAK70/35 | beige | 10 | 0340960000 | AP 100 GR | grey | 20 | 1773410000 |
| AP AST1+5 DB | dark beige | 20 | 0266400000 | AP DLI2.5 DB | dark beige | 20 | 1783550000 |
| AP ASK1 | beige | 20 | 0380360000 | AP DLD2.5/PE DB | dark beige | 20 | 1783800000 |
| AP SAK16 BL | blue | 20 | 0271180000 | AP VLI1.5 DB | dark beige | 20 | 1784150000 |
| AP DK4 | beige | 20 | 0359260000 | AP VLI1.5/PE DB | dark beige | 20 | 1784160000 |
| AP SAK2.5 GE | yellow | 20 | 0279500000 | AP DLD2.5 DB | dark beige | 20 | 1784210000 |
| AP SAK2.5 OR | orange | 20 | 0279540000 | AP 110 GR | grey | 10 | 1790080000 |
| AP SAK2.5L KRG BL | blue | 20 | 0279570000 | AP SAKR BE RS-SET | beige | 5 | 1820200000 |
| AP SAK2.5 BL | blue | 20 | 0279580000 | AP SAK4-10 GR 7042 | grey | 20 | 1853970000 |
| AP AKZ4 BL | blue | 20 | 0294480000 | AP 2 DSG1.5T | beige | 1 | 2119490000 |
| AP SAK95 KRG | blue | 10 | 0550920000 | AP PPT/35 | black | 10 | 3835120000 |
| AP DSK1.5 | beige | 20 | 0532960000 | AP RV | beige | 1 | 4145220000 |
| AP SAK35 KRG/BL | blue | 10 | 0303670000 | AP OSC 10/16 | beige | 10 | 9154850000 |
| AP DK4S | beige | 20 | 0631360000 | AP OSC 4 | beige | 10 | 9154860000 |
| AP SAK35/TW SAK16 BL | blue | 10 | 0303680000 | AP STA2.5 0.5MM | beige | 1 | 2012770000 |
| AP SAK2.5L KRG BL | blue | 20 | 0309270000 | AP KDKS1 1.5 | beige | 20 | 9503330000 |
| AP ADK1 | beige | 50 | 0476260000 | AP KDKS1 EN | beige | 20 | 9503340000 |
| AP AKZ1.5 BL | blue | 50 | 0340580000 | AP KSKM | beige | 20 | 9509630000 |
| AP SAK2.5/35 + AST3+4 | beige | 20 | 0460560000 | AP SAK4-10 GE | yellow | 1 | 2076890000 |
| AP TOP4SF-FF | beige | 20 | 0483460000 | AP SAK16 GE | yellow | 1 | 2076900000 |
| AP DK4 BL | blue | 20 | 0359280000 | AP SAK35/TW SAK16 GE | yellow | 1 | 2076910000 |
| AP ASK1 RT | red | 20 | 0380350000 | AP AST3+4/35 GE | yellow | 1 | 2077060000 |
| AP ASK1 BL | blue | 20 | 0380380000 | AP AKZ4 GE | yellow | 50 | 2077070000 |
| AP DLD2.5/PE | beige | 20 | 1595960000 | AP SAK2.5/35 | beige | 1 | 2144900000 |
| AP VLI1.5/PE | beige | 20 | 1633320000 | AP ATA1 | beige | 1 | 2093550000 |
| AP VLI1.5 | beige | 20 | 1633260000 | AP SAK4 KRG M.FU | dark beige | 20 | 0460020000 |
| AP MAK2.5 | beige | 20 | 1615280000 | AP DK4/380 Q | beige | 20 | 0438560000 |
| AP DK4Q | beige | 20 | 1397160000 | AP SAKB/C/T BE | beige | 1 | 4140450000 |
| AP DLI2.5 | beige | 20 | 1313260000 | AP SAKB/C/T1 DB | dark beige | 1 | 4173520000 |
| AP DLD2.5 | beige | 20 | 1317660000 | AP MAK2.5 DB | dark beige | 20 | 7917000000 |
| AP ST5 PPO/SW | black | 10 | 0447240000 | AP SAKK4/10 KER/WS | white | 10 | 9502630000 |
| AP ST5 PA/BE | beige | 10 | 0447260000 | AP KDKS1 1.5 DB | dark beige | 20 | 9532470000 |
| AP SAK2.5/35 DB | dark beige | 20 | 0460490000 | | | | |
| AP TW/SS.../35 | beige | 10 | 1333200000 | | | | |
| AP SAK2.5/35 BL | blue | 20 | 0460580000 | | | | |
| AP SAKS1+3 KRG | dark beige | 20 | 0191320000 | | | | |
| AP SAKD2.5N | beige | 20 | 0150960000 | | | | |
| AP SAKR KRG | dark beige | 20 | 0211320000 | | | | |
| AP TAL | beige | 20 | 0212260000 | | | | |
| AP SAKA KRG | dark beige | 20 | 0134220000 | | | | |
| AP SAK95 KRG/BL | blue | 10 | 0550970000 | | | | |
| AP SAKH6-10 KRG | dark beige | 20 | 0131720000 | | | | |
| AP SAKB/C/T KRG | dark beige | 20 | 0146720000 | | | | |
| AP AKA2.5 | beige | 100 | 0162520000 | | | | |
| AP DK4Q DB | dark beige | 20 | 0631300000 | | | | |
| AP DK4S BL | blue | 20 | 0631380000 | | | | |
| AP AKZ4 | blue | 20 | 0294460000 | | | | |
| AP AKZ4 KRG | dark beige | 20 | 0294420000 | | | | |
| AP SAK35/TW SAK16 | beige | 10 | 0303660000 | | | | |

Colour coding options

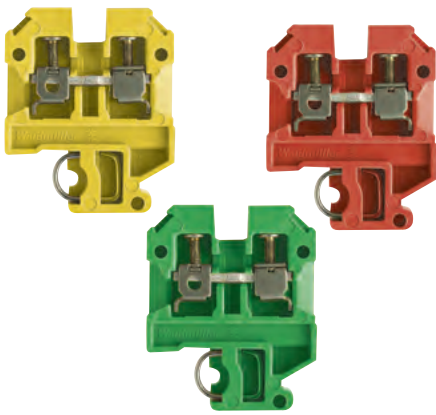

The colours listed here are available as standard. Other types of terminals in custom colours can be supplied on request, provided a minimum quantity is ordered.

| Type | Colour | Qty. | Order No. |
|-----------------------|--------------|------|------------|
| SAK 2.5 AL BLUE (E) | blue | 100 | 6253140000 |
| SAK 2.5 BL | blue | 100 | 0279680000 |
| SAK 2.5 BL RS-SET | blue | 10 | 1817860000 |
| SAK 2.5 KRG/BL | blue | 100 | 0279670000 |
| SAK 2.5 OR | orange | 100 | 1326360000 |
| SAK 2.5 SW 1X1 | black | 100 | 0108560000 |
| SAK 2.5 SW 1X1/KRG | black | 100 | 0108520000 |
| SAK 2.5/35 BL | blue | 100 | 0380480000 |
| SAK 2.5/35 DBL | blue | 100 | 1799920000 |
| SAK 2.5/35 GE | yellow | 100 | 1821480000 |
| SAK 2.5/35 KRG/BL | blue | 100 | 0380470000 |
| SAK 2.5/35 OR | orange | 100 | 0380440000 |
| SAK 2.5/35 RT | red | 100 | 1799910000 |
| SAK 2.5/35 SW | black | 100 | 1799900000 |
| SAK 2.5/35 SW 1X1 | black | 100 | 0514060000 |
| SAK 2.5/EN BL | blue | 100 | 0218680000 |
| SAK 2.5/EN BR | brown | 100 | 1858450000 |
| SAK 2.5/EN SW | black | 100 | 1858440000 |
| SAK 2.5/EN WS | white | 100 | 1858460000 |
| SAK 2.5/TC AL BL | blue | 100 | 0107180000 |
| SAK 2.5/TC CH BL | blue | 100 | 0107280000 |
| SAK 35/35 BL | blue | 20 | 0380780000 |
| SAK 35/EN BL | blue | 20 | 1784400000 |
| SAK 4 BL | blue | 100 | 0128380000 |
| SAK 4 BL RS-SET | blue | 10 | 1817780000 |
| SAK 4 EP/SW | black | 100 | 0128300000 |
| SAK 4 KRG BL | blue | 100 | 0128370000 |
| SAK 4 OR | orange | 100 | 0105060000 |
| SAK 4 SS/35 6.3 GR | grey | 100 | 0646930000 |
| SAK 4/35 BL | blue | 100 | 0443680000 |
| SAK 4/35 KRG/BL | blue | 100 | 0443670000 |
| SAK 4/35 OR | orange | 100 | 1323660000 |
| SAK 4/35/AP GG | green/yellow | 100 | 0443650000 |
| SAK 4/EN BL | blue | 100 | 0467480000 |
| SAK 4/EN BR | brown | 100 | 9130990000 |
| SAK 4/EN GE | yellow | 100 | 9129930000 |
| SAK 4/EN GN | green | 100 | 9129950000 |
| SAK 4/EN GR | grey | 100 | 9129960000 |
| SAK 4/EN GR 7042 | grey | 100 | 1853950000 |
| SAK 4/EN OR | orange | 100 | 0467400000 |
| SAK 4/EN RT | red | 100 | 9129920000 |
| SAK 4/EN SW | black | 100 | 9130980000 |
| SAK 4/EN WS | white | 100 | 1773340000 |
| SAK 6/35 BL | blue | 100 | 0380580000 |
| SAK 6/35 GN/GE | yellow | 100 | 1866850000 |
| SAK 6/35 KRG/BL | blue | 100 | 0380570000 |
| SAK 6/EN BL | blue | 100 | 0212880000 |
| SAK 6/EN GE | yellow | 100 | 1772820000 |
| SAK 6/EN OR | orange | 100 | 1772810000 |
| SAK 6/EN RT | red | 100 | 0212840000 |
| SAK 6/EN SW | black | 100 | 0212810000 |
| SAK 6/EN WS | white | 100 | 1773350000 |
| SAK 6N BL | blue | 100 | 0193280000 |
| SAK 10 BL | blue | 100 | 0110080000 |
| SAK 10 KRG/BL | blue | 100 | 0110070000 |
| SAK 10 OR | orange | 100 | 0110040000 |
| SAK 10/35 BL | blue | 100 | 0443780000 |
| SAK 10/35 KRG/BL | blue | 100 | 0443770000 |
| SAK 10/EN BL | blue | 100 | 1784410000 |
| SAK 10/EN GR RAL 7042 | grey | 100 | 1853960000 |
| SAK 10/EN OR | orange | 100 | 1772830000 |
| SAK 10/EN SW | black | 100 | 1773900000 |
| SAK 16 BL | blue | 50 | 0271080000 |
| SAK 16/35 BL | blue | 50 | 0380680000 |
| SAK 16/EN BL | blue | 50 | 1784390000 |
| SAK 70 KRG/BL | blue | 10 | 0340870000 |
| SAK 95/35 KRG/BL | blue | 10 | 0662270000 |
| SAKC 4/2STB7 BL | blue | 100 | 0340670000 |
| SAKD 2.5/35 BL | blue | 100 | 0268880000 |
| SAKD 2.5N BL | blue | 100 | 0215580000 |
| SAKH 6 EP/SW | black | 50 | 0126600000 |

| Type | Colour | Qty. | Order No. |
|-----------------|--------|------|------------|
| SAKH 10 EP/SW | black | 50 | 0126700000 |
| SAKH 35 EP/SW | black | 20 | 1596240000 |
| SAKR 2STB BL | blue | 100 | 0412280000 |
| SAKR BL | blue | 100 | 0412180000 |
| SAKR OR | orange | 100 | 1461960000 |
| SAKR/35 2STB BL | blue | 100 | 0183380000 |
| SAKR/35 BL | blue | 100 | 0172180000 |
| SAKR/35 WS | white | 100 | 0172190000 |

Cross-connection systems

Cross-connections across more than 10 modular terminals

The SAKD 2.5 N, SAK 2.5, SAK 4 and SAK 6 N terminals include the option of setting up a cross-connection with more than 10 poles, e.g. 20-pole:

2 No. Q 10 + 1 No. QL 2.

The end fixing screws are removed from the Q 10 links by unscrewing them from the VH sleeves. The QL 2 is positioned between these and the two fixing screws screwed into their VH sleeves again. This arrangement allows 20 poles to be crossconnected.

Q pre-assembled cross-connectors

The pre-assembled cross-connector has the appropriate number of cross-connection links, cross-connection sleeves and fixing screws to match the number of poles required already installed in a captive arrangement. Such pre-assembled cross-connectors merely have to be inserted into the appropriate terminals during installation. These crossconnectors can be supplied in 2-, 3-, 4- and 10-pole versions.

QL cross-connection links

Cross-connection links are used to provide cross-connections with equal potential across several modular terminals. The cross-connection links are made from copper or brass with an electroplated tin coating, and can be supplied in lengths to suit 2, 3, 4 and 10 poles, to match the respective terminal width. The electrical connection between the cross-connection link and the busbar of the modular terminal is by way of a connecting sleeve.

BS fixing screws

A steel fixing screw is used to connect the cross-connection link to the connecting sleeve on the busbar under a modular terminal. It is the purpose of the steel screw to provide a secure mechanical fixing between the cross-connection and the busbar. Two types of screw are used: form A has a full-length thread, and form B has a plain shaft below the head with a captive washer.

VH connecting sleeves

The length of the connecting sleeve is matched to the size of the terminal. The sleeves are made from tin-coated copper or brass. One connecting sleeve must be used for every terminal to be cross-connected.

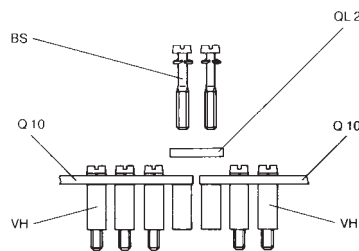
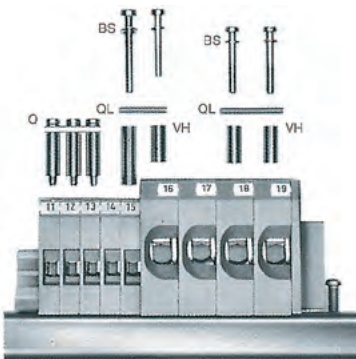

Cross-connection systems

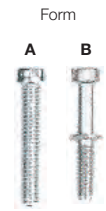
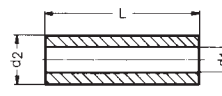
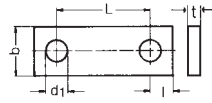

| Q | | QL | | VH | | BS | | | | | | | | | | | | | |
|------------------------------------|-------|--------------------------------|------------|------------------------|------------|---|-----|-----------------------------------|-----|-----|---------------|-----------|------------|------|-----|----------------|------------|---|--------|
| Rated current of modular terminals | | Pre-assembled cross-connection | | Cross-connection links | | Continuous current rating of cross-connection | | Connecting sleeves without thread | | | Fixing screws | | | | | | | | |
| Type | A | Type Poles | Order No. | Type Poles | Order No. | Dimensions | | | | | Type Length | Order No. | L | d2 | d1 | Size Order No. | Form | M | |
| SAK 2.5 | 24 A | Q 2 | 0370000000 | QL 2 | 0155900000 | 6 | 0.6 | 6 | 3.4 | 2.4 | 32 A | VH 8 | 0266700000 | 8 | 4.9 | 3.2 | 0359000000 | B | 3 x15 |
| | | Q 3 | 3710000000 | QL 3 | 0156000000 | | | | | | 32 A | | | | | | | | |
| | | Q 4 | 3720000000 | QL 4 | 0156100000 | | | | | | 32 A | | | | | | | | |
| | | Q 10 | 0368700000 | QL 10 | 0338100000 | | | | | | 32 A | | | | | | | | |
| SAK 4 | 32 A | Q 2 | 0336700000 | QL 2 | 0130600000 | 6 | 0.6 | 6.5 | 3.4 | 2.5 | 41 A | VH 13.5 | 0248500000 | 13.5 | 5 | 3.2 | 0303000000 | B | 3x20 |
| | | Q 3 | 0336800000 | QL 3 | 0130700000 | | | | | | 41 A | | | | | | | | |
| | | Q 4 | 0336900000 | QL 4 | 0130800000 | | | | | | 41 A | | | | | | | | |
| | | Q 10 | 0368800000 | QL 10 | 0338200000 | | | | | | 36 A | | | | | | | | |
| SAK 6 N | 41 A | Q 2 | 0456700000 | QL 2 | 0194300000 | 6 | 1 | 8 | 3.4 | 3 | 41 A | VH 12 | 0249000000 | 12 | 5 | 3.2 | 0303000000 | B | 3x20 |
| | | Q 3 | 0456800000 | QL 3 | 0194400000 | | | | | | 41 A | | | | | | | | |
| | | Q 4 | 0456900000 | QL 4 | 0194500000 | | | | | | 41 A | | | | | | | | |
| | | Q 10 | 0457000000 | QL 10 | 0338300000 | | | | | | 41 A | | | | | | | | |
| SAK 10 | 57 A | Q 2 | 0457100000 | QL 2 | 0470300000 | 6 | 2 | 10 | 3.4 | 3.5 | 57 A | VH 12 | 0249000000 | 12 | 5 | 3.2 | 0303000000 | B | 3x20 |
| | | Q 3 | 0457200000 | QL 3 | 0470400000 | | | | | | 57 A | | | | | | | | |
| | | Q 4 | 0457300000 | QL 4 | 0470500000 | | | | | | 57 A | | | | | | | | |
| | | Q 10 | 0457400000 | QL 10 | 0470600000 | | | | | | 57 A | | | | | | | | |
| SAK 16 | 76 A | Q 2 | 0457500000 | QL 2 | 0470700000 | 6 | 2 | 12 | 3.4 | 4 | 76 A | VH 12 | 0249000000 | 12 | 5 | 3.2 | 0303000000 | B | 3x20 |
| | | Q 3 | 0457600000 | QL 3 | 0470800000 | | | | | | 76 A | | | | | | | | |
| | | Q 4 | 0457700000 | QL 4 | 0470900000 | | | | | | 76 A | | | | | | | | |
| | | Q 10 | 0457800000 | QL 10 | 0471000000 | | | | | | 76 A | | | | | | | | |
| SAK 35 N | 125 A | | | QL 2 | 0564900000 | 8 | 3 | 16 | 4.5 | 5 | 99 A | VH 17 | 0267000000 | 17 | 8 | 5 | 0267100000 | A | 4x30 |
| | | | | QL 3 | 0565000000 | | | | | | 99 A | | | | | | | | |
| | | | | QL 4 | 0565100000 | | | | | | 99 A | | | | | | | | |
| | | | | QL 10 | 0565200000 | | | | | | 99 A | | | | | | | | |
| SAK 35 | 125 A | | | QL 2 | 0123600000 | 8 | 3 | 18 | 4.5 | 5 | 99 A | VH 17 | 0267000000 | 17 | 8 | 5 | 0267100000 | A | 4x30 |
| | | | | QL 3 | 0123700000 | | | | | | 99 A | | | | | | | | |
| | | | | QL 4 | 0123800000 | | | | | | 99 A | | | | | | | | |
| | | | | QL 10 | 0338600000 | | | | | | 99 A | | | | | | | | |
| SAK 70 | 192 A | | | QL 2 | 0345300000 | 14 | 4 | 22 | 5.5 | 7 | 180 A | VH 30.5 | 0345500000 | 30.5 | 11 | 5.5 | 0345600000 | A | 5x45 |
| | | | | QL 3 | 0167000000 | | | | | | 180 A | | | | | | | | |
| SAK 95 | 232 A | | | QL 2 | 0551200000 | 14 | 4 | 28 | 6 | 7 | 180 A | VH 35 | 0551100000 | 35 | 11 | 5.5 | 0630200000 | B | 5x50 |
| | | | | QL 3 | 0407600000 | | | | | | 180 A | | | | | | | | |
| | | | | QL 4 | 0407700000 | | | | | | 180 A | | | | | | | | |
| SAKS 1 | 6,3 A | | | QL 2 | 0191400000 | 6 | 2 | 12.9 | 3.4 | 3 | 47 A | | | | | | 0346200000 | B | 3 x 6 |
| SAKS 3 | 10 A | | | QL 3 | 0191500000 | | | | | | 47 A | | | | | | | | |
| SAKS 6 | 10 A | | | QL 4 | 0191600000 | | | | | | 47 A | | | | | | | | |
| SAKS 7 | 10 A | | | QL 10 | 0338800000 | | | | | | 36 A | | | | | | | | |
| SAKS 4 | 16 A | | | QL 2 | 0328000000 | 10 | 4 | 24 | 4.8 | 5 | 47 A | | | | | | 0199700000 | A | 3 x 7 |
| | | | | QL 3 | 0328100000 | | | | | | 47 A | | | | | | 0103300000 | A | 4 x 9 |
| | | | | QL 4 | 0328200000 | | | | | | 47 A | | | | | | | | |
| | | | | QL 10 | 0339000000 | | | | | | 36 A | | | | | | | | |
| SAKS 2 | 10 A | | | QL 2 | 0207800000 | 10 | 4 | 27.6 | 4.8 | 6.5 | 47 A | | | | | | 0103300000 | A | 4 x 9 |
| SAKS 5 | 63 A | | | QL 3 | 0207900000 | | | | | | 47 A | | | | | | | | |
| | | | | QL 4 | 0208000000 | | | | | | 47 A | | | | | | | | |
| | | | | QL 10 | 0338900000 | | | | | | 36 A | | | | | | | | |
| DK 4 Q | 41 A | Q 2 | 0336400000 | QL 2 | 0297200000 | 4 | 0.8 | 6.1 | 2.8 | 2.5 | 32 A | VH 5 | 0296800000 | 5 | 4 | 2.7 | 0400100000 | B | 2.5x11 |
| DKB 4 Q/10 | 41 A | Q 3 | 0336500000 | QL 3 | 0297300000 | | | | | | 32 A | | | | | | | | |

Cross-connection systems

Cross-connections between terminals of different sizes to increase the cross-section

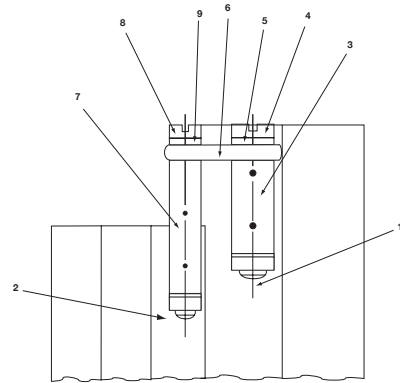
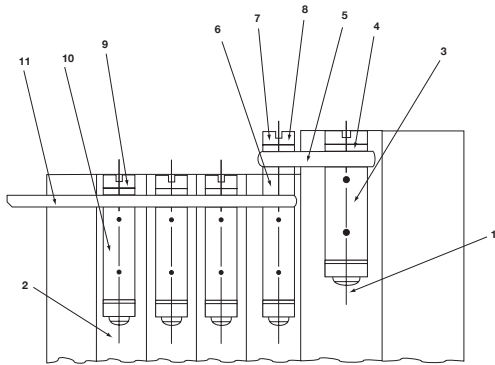

| Terminal | Position | Type | Order No. | Current |
|-----------------------|----------|-------------|------------|---------|
| from SAK 16 | 1 | - | - | - |
| sleeve | 3 | VH 12 | 0249000000 | - |
| screw | 4 | BS M 3 x 20 | 0303000000 | - |
| to SAK 6 N | 2 | - | - | - |
| cross-connection link | 5 | QL 2 | 0470300000 | - |
| sleeve | 6 | VH 4,5 | 0303200000 | - |
| screw | 7 | BS M 3 x 25 | 0292500000 | - |
| washer | 8 | SS M 3 | 0164400000 | - |
| screw | 9 | BS M 3 x 20 | 0303000000 | - |
| sleeve | 10 | VH 12 | 0249000000 | - |
| cross-connection link | 11 | QL 2 | 0194300000 | 47 A |
| cross-connection link | 11 | QL 3 | 0194400000 | 47 A |
| cross-connection link | 11 | QL 4 | 0194500000 | 47 A |
| cross-connection link | 11 | QL 10 | 0338300000 | 36 A |
| to SAK 2.5 | 2 | - | - | - |
| cross-connection link | 5 | QL 2 | 0470300000 | - |
| sleeve | 6 | VH 12 | 0249000000 | - |
| screw | 7 | BS M 3 x 30 | 0296200000 | - |
| retaining screw | 8 | SS M 3 | 0164400000 | - |
| screw | 9 | BS M 3 x 15 | 0359000000 | - |
| sleeve | 3 | VH 12.5 | 0308000000 | - |
| sleeve | 3 | VH 8 | 0266700000 | - |
| cross-connection link | 11 | QL 2 | 0155900000 | 27 A |
| cross-connection link | 11 | QL 3 | 0156000000 | 27 A |
| cross-connection link | 11 | QL 4 | 0156100000 | 27 A |
| cross-connection link | 11 | QL 10 | 0338100000 | 27 A |
| from SAK 10 | 1 | - | - | - |
| screw | 4 | BS M 3 x 20 | 0303000000 | - |
| to SAK 4 | 2 | - | - | - |
| sleeve | 3 | VH 13.5 | 0248500000 | - |
| cross-connection link | 5 | QL 2 | 1443000000 | - |
| screw | 7 | BS M 3 x 20 | 0303000000 | - |
| screw | 9 | BS M 3 x 20 | 0303000000 | - |
| sleeve | 10 | VH 13.5 | 0248500000 | - |
| cross-connection link | 11 | QL 2 | 0130600000 | 36 A |
| cross-connection link | 11 | QL 3 | 0130070000 | 36 A |
| cross-connection link | 11 | QL 4 | 0130800000 | 36 A |
| cross-connection link | 11 | QL 10 | 0338200000 | 36 A |
| to SAK 2.5 | 2 | - | - | - |
| cross-connection link | 5 | QL 2 | 0193400000 | 36 A |
| sleeve | 1 | VH 13 | 0304000000 | - |
| screw | 4 + 7 | BS M 3 x 20 | 0303000000 | - |
| screw | 9 | BS M 3 x 15 | 0359000000 | - |
| sleeve | 10 | VH 8 | 0266700000 | - |
| cross-connection link | 11 | QL 2 | 0155900000 | 27 A |
| cross-connection link | 11 | QL 3 | 0156000000 | 27 A |
| cross-connection link | 11 | QL 4 | 0156100000 | 27 A |
| cross-connection link | 11 | QL 10 | 0338100000 | 27 A |
| sleeve | 3 | VH 13 | 0304000000 | - |
| sleeve | 3 | VH 6.5 | 0286400000 | - |

| Terminal | Position | Type | Order No. | Current |
|-----------------------|----------|-------------|------------|---------|
| von SAK 35 | 1 | - | - | - |
| sleeve | 3 | VH 17 | 0267000000 | - |
| screw | 4 | BS M 4 x 30 | 0267100000 | - |
| washer | 5 | SS M 4 | 0136400000 | - |
| zu SAK 10 N | 2 | - | - | - |
| cross-connection link | 5 | QL 2 | 0207400000 | 47 A |
| sleeve | 6 | VH 4,5 | 0303200000 | - |
| screw | 8 | BS M 3 x 35 | 0309800000 | - |
| washer | 9 | SS M 3 | 0164400000 | - |
| zu SAK 6 N | 2 | - | - | - |
| cross-connection link | 6 | QL 2 | 0207400000 | 47 A |
| sleeve | 7 | VH 27 | 0309400000 | - |
| screw | 8 | BS M 3 x 35 | 0309800000 | - |
| retaining screw | 9 | SS M 3 | 0164400000 | - |
| von SAK 35 N | 1 | - | - | - |
| sleeve | 3 | VH 17 | 0267000000 | - |
| screw | 4 | BS M 4 x 30 | 0267100000 | - |
| retaining screw | 5 | SS M 4 | 0136400000 | - |
| zu SAK 10 | 2 | - | - | - |
| cross-connection link | 6 | QL 2 | 0207400000 | 47 A |
| sleeve | 7 | VH 27 | 0309400000 | - |
| screw | 8 | BS M 3 x 35 | 0309800000 | - |
| retaining screw | 9 | SS M 3 | 0164400000 | - |
| zu SAK 6 N | 2 | - | - | - |
| cross-connection link | 6 | QL 2 | 0135500000 | 47 A |
| sleeve | 7 | VH 27 | 0309400000 | - |
| screw | 8 | BS M 3 x 35 | 0309800000 | - |
| retaining screw | 9 | SS M 3 | 0164400000 | - |
| von SAK 10 | 1 | - | - | - |
| sleeve | 3 | VH 12.5 | 0300800000 | - |
| screw | 4 | BS M 3 x 20 | 0303000000 | - |
| retaining screw | 5 | SS M 3 | included | - |
| zu SAK 35 N | 1 | - | - | - |
| sleeve | 3 | VH 13 | 0304000000 | - |
| screw | 4 | BS M 3 x 20 | 0303000000 | - |
| washer | 5 | SS M 3 | included | - |
| zu SAK 2.5 | 2 | - | - | - |
| cross-connection link | 6 | QL 2 | 0130600000 | 27 A |
| sleeve | 7 | VH 16 | 0309700000 | - |
| screw | 8 | BS M 3 x 20 | 0303000000 | - |
| retaining screw | 9 | SS M 3 | included | - |

Screw-in cross-connectors (Q)

In this type of cross-connection the cross-connection link, connecting sleeves and fixing screws are pre-assembled in a captive arrangement. However, all the individual parts are also available separately on request. During installation, these pre-assembled cross-connectors are simply inserted into the cross-connection slot in the middle of the terminal and screwed tight. Any number of poles can be achieved by linking two cross-connections. For example, a 20-pole cross-connection by joining together two 10-pole cross-connections with the cross-connection link of a 2-pole cross-connection (see figure below)..

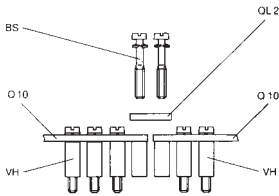

Q ... AKZ 4SS



| Technical specification | |
|---------------------------------------|-------|
| continuous current, 2-pole/multi-pole | A |
| thread size | M 2.5 |
| tightening torque | Nm |

| Ordering data | |
|---------------|----------------|
| 2-pole | Q...2 AKZ 4SS |
| 3-pole | Q...3 AKZ 4SS |
| 4-pole | Q...4 AKZ 4SS |
| 10-pole | Q...10 AKZ 4SS |
| 24-pole | |

| Type | Qty. | Order No. |
|----------------|------|------------|
| Q...2 AKZ 4SS | 50 | 0369000000 |
| Q...3 AKZ 4SS | 50 | 0369100000 |
| Q...4 AKZ 4SS | 50 | 0369200000 |
| Q...10 AKZ 4SS | 20 | 0369300000 |

for terminal
AKZ 4SS

Q ... DLI 2.5



| Type | Qty. | Order No. |
|----------------|------|------------|
| Q...2 DLI 2..5 | 50 | 1312500000 |
| Q...3 DLI 2..5 | 50 | 1312600000 |
| Q...4 DLI 2.5 | 50 | 1312700000 |
| Q...10 DLI 2.5 | 20 | 1313100000 |

for terminal
DLI 2.5
DLA 2.5
DLD 2.5

Q ... AKZ 1.5



| Technical specification | |
|---------------------------------------|-------|
| continuous current, 2-pole/multi-pole | A |
| thread size | M 2.5 |
| tightening torque | Nm |

| Ordering data | |
|---------------|----------------|
| 2-pole | Q...2 AKZ 1.5 |
| 3-pole | Q...3 AKZ 1.5 |
| 4-pole | Q...4 AKZ 1.5 |
| 10-pole | Q...10 AKZ 1.5 |
| 24-pole | |

| Type | Qty. | Order No. |
|----------------|------|------------|
| Q...2 AKZ 1.5 | 50 | 0368200000 |
| Q...3 AKZ 1.5 | 50 | 0368300000 |
| Q...4 AKZ 1.5 | 50 | 0368400000 |
| Q...10 AKZ 1.5 | 20 | 0368500000 |

for terminal
AKZ 1.5
AKZ 2.5

Q ... AKZ 4



| Type | Qty. | Order No. |
|--------------|------|------------|
| Q...2 AKZ 4 | 50 | 0336400000 |
| Q...3 AKZ 4 | 50 | 0336500000 |
| Q...4 AKZ 4 | 50 | 0336600000 |
| Q...10 AKZ 4 | 20 | 0338600000 |

for terminal
AKZ 4

Potential distribution

Removable cross-connection links

Removable cross-connection links are intended for 2-pole, easily disconnected cross-connections. They are fitted together with a VH connecting sleeve and a BS fixing screw.

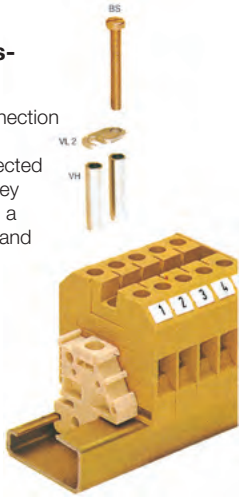

VL 2

Removable cross-connection links



| for terminal |
|--------------|
| SAK 4 |
| SAK 6 N |
| SAK 10 |
| SAK 16 |
| SAK 35 |

| Type | Qty. | Order No. |
|------|------|-----------|
| VL 2 | 50 | 019700000 |
| VL 2 | 50 | 019470000 |
| VL 2 | 50 | 013590000 |
| VL 2 | 50 | 013580000 |
| VL 2 | 50 | 012400000 |

VH

Connecting sleeves



| Type | Qty. | Order No. |
|---------|------|-----------|
| VH 19 | 50 | 028510000 |
| VH 19 | 50 | 028510000 |
| VH 19 | 50 | 028510000 |
| VH 19 | 50 | 028510000 |
| VH 24,5 | 50 | 029870000 |

BS

Fixing screws



| Type | Qty. | Order No. |
|----------|------|-----------|
| BS M3x25 | 100 | 029250000 |
| BS M3x25 | 100 | 029250000 |
| BS M3x25 | 100 | 029250000 |
| BS M4x35 | 50 | 029890000 |

Spacer pillars

The DS spacer pillars are made from a tempered insulating material and are used so that individual current paths can be disconnected by removing the fixing screw. The current in the cross-connection is fed via the fixing screw in this arrangement. Therefore, we prescribe the use of screws made from CuNi 60 (a copper-nickel alloy). The use of an end bracket with a screw holder avoids losing fixing screws that have been removed.

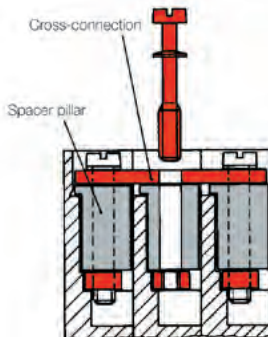

Spacer pillars type DS

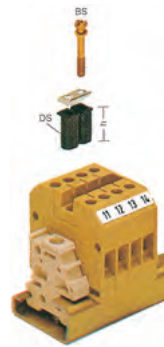

| for terminal |
|-------------------|
| SAK 2.5 |
| SAK 4 |
| SAK 6 N |
| SAK 10 and SAK 16 |

| Type | Qty. | Order No. |
|----------------|------|-----------|
| DS 9* | 100 | 033093000 |
| BS M 3x15 CuNi | 100 | 037720000 |
| DS 14* | 100 | 020753000 |
| BS M 3x20 CuNi | 100 | 037710000 |
| DS 12,5* | 100 | 020773000 |
| BS M 3x20 CuNi | 100 | 037710000 |
| DS 12,5* | 100 | 020763000 |
| BS M 3x20 CuNi | 100 | 037710000 |

* Height in mm

EW 35

End bracket for TS 35 with screw holder for fixing screws that have been removed.



| Type | Qty. | Order No. |
|------------------------------|------|-----------|
| EW35/TS 35 with screw holder | 20 | 025866000 |

EWK 2

End bracket for TS 32 with screw holder for fixing screws that have been removed.



| Type | Qty. | Order No. |
|-------------------------------|------|-----------|
| EWK 2/TS 32 with screw holder | 20 | 025876000 |

Rail holder

For an insulated terminal rail arrangement in fully insulated installations.

SH 2



| for terminal |
|--|
| EK 2.5 N, EK 2.5/35, EK 4, EK 4/35, EK 6/35, EK 10, EK 10/35, EK 16, EK 16/35, EK 35, EK 35/35 |

| Type | Qty. | Order No. |
|------|------|-----------|
| SH2 | 10 | 049492000 |

Testing/Checking

Test plugs/Sockets

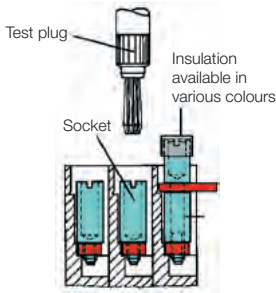

Test plugs (PS) are used for measurement purposes or for the final checking of a finished terminal strip installation. Test plugs for sockets are available with 2.3 and 4 mm I.D. The difference between these and a test adapter is that the test plug does not automatically clip into the terminal. This means that a secure connection to modular feed-through terminals up to 35 mm² is only possible in conjunction with a socket.

The **sockets (StB)** enable the PS test plug and the QS plug-in cross-connectors to be plugged in. The sockets are screwed into the busbar in the cross-connection slot in the middle of the terminal or screwed into the modular terminal instead of the clamping screw.

If a cross-connection has to provide a test option as well, then an StB 28.5 or 30.5, which has an insulating sleeve and can accommodate the PS 4 test plug, is screwed in instead of the fixing screw.

PS



| Type | Qty. | Order No. |
|--|------|------------|
| 2.3 mm dia./rated current 17.5 A PS 2.3 | 20 | 0180400000 |
| 4.0 mm dia./rated current 24 A PS 4 | 20 | 0299600000 |

PS 2 / PS 2 MC



| Type | Qty. | Order No. |
|--|------|------------|
| PS 2 for 2 mm dia. sockets for soldered conductor cross-section 1.5 mm ² | 20 | 0293800000 |
| PS 2 MC for soldered conductor cross-section 0.75 mm ² , can also be plugged directly into threaded hole in busbar for terminal types AKZ 4, AKB 4, AKZ 2.5, AKZ 1.5 | 20 | 0310000000 |

ZS 2.3/4



| Type | Qty. | Order No. |
|--|------|------------|
| ZS 2.3/4 Adapter plug for connecting sockets with 2.3 and 4 mm I.D. Can also be plugged directly into threaded hole in busbar for terminal types SAK 2.5 and SAK 4. | 20 | 0249600000 |

FZS 2/4 / FK 4



| Type | Qty. | Order No. |
|--|------|------------|
| FZS 2/4 Flexible adapter plug for connecting sockets with 2.3 and 4 mm I.D. | 20 | 1276300000 |
| FK 4 Flexible coupling for connecting test plug to test adapter. The unconnected end of the conductor is protected against fraying by a wire end ferrule. | 20 | 1678650000 |

TA 1



| Type | Qty. | Order No. |
|--|------|------------|
| TA 1 The conductor is soldered on, or crimped on with the HTG 58 crimping pliers. | 20 | 0535860000 |
| HTG 58 conductor: max. 0.75 mm ² remove shoulder stripping length: 14 mm | 1 | 9012000000 |

The SAKR modular disconnect terminals are available already fitted with sockets (see "Modular disconnect terminals"). These sockets are provided with a slot for actuating with a screwdriver. Weidmüller can supply special screwdrivers with a shoulder for this purpose (chapter J).

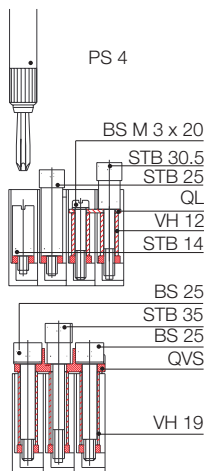

StB for SAKT

The type StB 25 socket accepts test plug PS 4 in type SAKT 1 and SAKT 2 disconnect terminals, or the QS plug-in cross connector.

The type StB 35 socket is used when simultaneous testing is necessary with a QVS cross-connection slider.

Complete with insulating sleeve to prevent contact with live parts and colour-coded test plug and plug-in cross-connection, 4 mm dia.

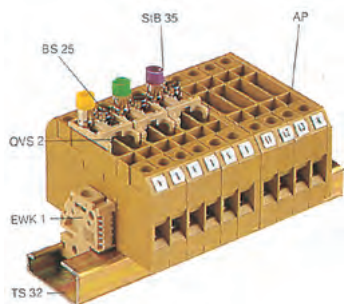

StB 5.5...17

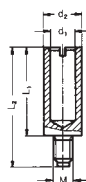

| Type | for terminal type | L1 | L2 | d1 | d2 | M | Qty. | Order No. |
|----------|--------------------------------|------|------|-----|-----|-----|------|------------|
| StB 5.5 | SAKL 4/20 1) | 5,5 | 11 | 2,3 | 3,7 | 3 | 100 | 0122700000 |
| StB 6 | AKZ 4, DK 4, SAKR 1) | 6 | 11,5 | 2,3 | 3,9 | 3 | 100 | 0379400000 |
| StB 6 | SAK 2.5 1) | 6 | 13 | 2,3 | 3,9 | 2,5 | 50 | 0130200000 |
| StB 7 | SAKC4, SAK4 1) | 7 | 14,5 | 2,3 | 4 | 3 | 100 | 0358500000 |
| StB 7.5 | SAK 10, SAKB 10 1) | 7,5 | 17 | 4 | 6 | 4 | 50 | 0130000000 |
| StB 8.5 | AKZ 4 / DK 4/ SAKD 2.5 N | 8,5 | 11,5 | 2,3 | 4 | 2,5 | 50 | 0215700000 |
| StB 8.5 | SAK 2.5 | 8,5 | 12 | 2,3 | 5 | 3 | 50 | 0280600000 |
| StB 8.5 | SAKT 4 | 8,5 | 12 | 2 | 4,5 | 3 | 50 | 0244600000 |
| StB 13.5 | SAKA 10 / SAKC 10 | 13,5 | 18,5 | 4 | 6 | 4 | 50 | 0135200000 |
| StB 14 | SAK 4 | 14 | 17,5 | 2,3 | 5 | 3 | 50 | 0168600000 |
| StB 14 | SAK6N, 10, 16 / SAKT 1, SAKT 2 | 14 | 19 | 4 | 6 | 3 | 50 | 0169900000 |
| StB 16 | SAK70, SAK 95 | 16 | 28 | 4 | 7 | 5 | 50 | 0385400000 |
| StB 16 | SAK 35, SAKB 10 | 16 | 23 | 4 | 7 | 4 | 50 | 0140200000 |
| StB 17 | SAKC 10 | 17 | 22 | 4 | 6 | 4 | 50 | 0147100000 |

StB 28.5 / 30.5

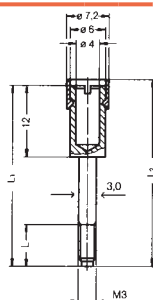

| Type | Colour | terminal type | L1 | L2 | L | Qty. | Order No. |
|----------|--------|----------------|------|------|---|------|------------|
| StB 30.5 | black | SAK 4, SAK 6 N | 30.5 | 31.7 | 7 | 50 | 0341000000 |
| StB 30.5 | grey | SAK 10, SAK 16 | - | - | - | 50 | 0341100000 |
| StB 30.5 | blue | - | - | - | - | 50 | 0341200000 |
| StB 30.5 | red | - | - | - | - | 50 | 0341300000 |
| StB 30.5 | green | - | - | - | - | 50 | 0341400000 |
| StB 30.5 | yellow | - | - | - | - | 50 | 0341500000 |
| StB 30.5 | violet | - | - | - | - | 50 | 0341600000 |
| StB 28.5 | black | SAK 2.5 | 28.5 | 29.7 | 9 | 50 | 0133400000 |

StB 25



| Type | Colour | for terminal type | Qty. | Order No. |
|--------|--------|-------------------|------|------------|
| StB 25 | yellow | SAKT 1 and SAKT 2 | 50 | 0267200000 |
| | green | | 50 | 0271200000 |
| | violet | | 50 | 0271300000 |
| | black | | 50 | 0271500000 |
| | grey | | 50 | 0271400000 |
| | blue | | 50 | 0343400000 |
| | red | | 50 | 0343300000 |

StB 35

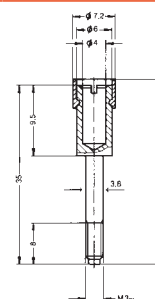

| Type | Colour | for terminal type | Qty. | Order No. |
|--------|--------|-------------------|------|------------|
| StB 35 | yellow | SAKT 1 and SAKT 2 | 50 | 0389000000 |
| | green | | 50 | 0388900000 |
| | violet | | 50 | 0389100000 |
| | black | | 50 | 0388500000 |
| | grey | | 50 | 0388600000 |
| | blue | | 50 | 0388700000 |
| | red | | 50 | 0388800000 |

¹⁾ used instead of the clamping screw

Protective covers

Protective covers

Several safety regulations, e.g. the German accident prevention code covering electrical systems and equipment (VBG 4) or the standard VDE 0106 part 100 (March 1983), call for live parts of electrical systems to be protected against direct contact by any part of the body.

In the case of modular terminals this protection must always be provided in the form of additional covers when cross-connectors or test sockets are fitted. Therefore, Weidmüller can supply cover strips with associated retaining plates which can be used with the more common sizes of terminal. The retaining plates can be fitted at the ends or within the terminal strip, and can be fitted to TS 32, TS 35 or TS 15 terminal rails.

Spacing of retaining plates:

The length of the ADP 1, 2 and 3 between retaining plates should not exceed about 500 mm. The cover strip is clipped into tabs on the side. Additional security is provided by a spigot on the retaining plate, which can also be sealed with lead. On terminal type SAK 95 the ADP 3 cover strip can be clipped directly onto the terminal. Transparent cover strips enable the terminals with their accessories and labelling to remain visible at all times. Additional labelling, e.g. for groups, can be added.

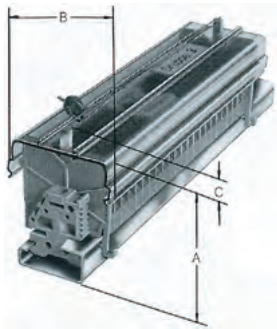

ADP

Cover strips

Unplasticised PVC, supplied in 1 m pieces, max. temperature 70°C



| transparent | |
|-----------------|------------|
| Type | Order No. |
| ADP 1 | 0485200000 |
| ADP 2 | 0485300000 |
| ADP 3 | 0485400000 |
| grey | |
| Type | Order No. |
| ADP 4 (1000 mm) | 1430760000 |
| ADP 4 (300 mm) | 1378160000 |
| TSK 31.5 | 0347960000 |

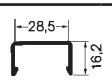
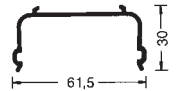
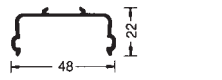

HP

Retaining plates

PA 66, 2 mm thick



| For fitting to TS 35 and TS 32, with spigot for lead seal | |
|---|------------|
| Type | Order No. |
| HP 1 | 0485560000 |
| HP 2 | 0485660000 |
| HP 3 | 0485760000 |
| HP 4 | 0485860000 |
| For fitting to TS 15 | |
| Type | Order No. |
| HP 7 | 0258260000 |
| HP 8 | 0258360000 |

Spigot for lead seal

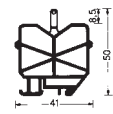
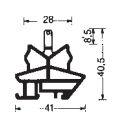
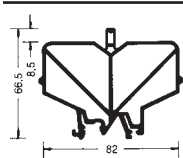
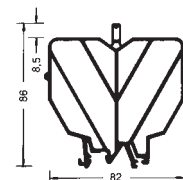
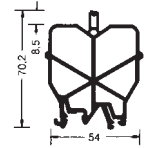
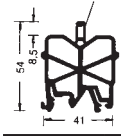

| Overall dimensions | A | A | A | A | B | C |
|---|-------|-------------|------------|-------|------|------------|
| for mounting on terminal rail | TS 32 | TS 35 x 7.5 | TS 35 x 15 | TS 15 | | |
| ADP 1, HP 1 | 61 | 56 | 63 | | 49 | 6 |
| ADP 2, HP 2 | 77 | 72 | 79 | | 62.5 | 6 |
| ADP 3, HP 3 | 94 | 89 | 86 | | 92 | 6 |
| ADP 3, HP 4 | 73.5 | 68.5 | 75.5 | | 92 | 6 |
| ADP 1, HP 8 | | | | 45 | 49 | 6 |
| TSK 31.5, HP 7 | | | | 35 | 31 | 6 |
| Labelling material | | | | | Qty. | Order No. |
| "Lightning flash" symbol, self-adhesive, 20 labels per card | | | | | 5 | 0566700000 |

* only for PA 66 versions

| Allocation to some terminal types | ADP cover strips | | | HP retaining plates | | |
|---|------------------|------|------------|---------------------|------|------------|
| | Type | Qty. | Order No. | Type | Qty. | Order No. |
| SAKD 2.5 N, EK 2.5 N, SAK 2.5, SAK 2.5/35 | ADP 1 | 36 | 0485200000 | HP 1 | 20 | 0485560000 |
| SAK 4, EK 4, SAK 4/35, EK 2.5/35, EK 4/35 | ADP 2 | 36 | 0485300000 | HP 2 | 20 | 0485660000 |
| SAK 6 N, EK 10, SAK 10, EK 6/35, SAK 6/35, EK 10/35 | | | | | | |
| SAKR, SAKR-D, DK 4 | | | | | | |
| SAK 16, EK 16, EK 35, SAK 35, SAKC 4, SAK 16/35 | ADP 3 | 20 | 0485400000 | HP 3 | 20 | 0485760000 |
| SAKC 10, SAK 70, SAKS 1, SAKS 2, Sak 35/35, SAK 70/35 | | | | | | |
| SAKS 3, SAKS 4, SAKS 5 | | | | | | |
| SAK 95 | ADP 3 | 1 | 0485400000 | not applicable | | |
| ASK 1, SAKA 10, SAKT 1, SAKB 10, SAKT 2, | ADP 3 | 1 | 0485400000 | HP 4 | 20 | 0485860000 |
| AST*, SAK 2.5, SAK 4 | ADP 4 | 1 | 1430760000 | not applicable | | |
| | ADP 1 | 1 | 0485200000 | HP 8 | 20 | 0258360000 |
| | | | | not applicable | | |
| 1000 mm long | | | 1 | 1430760000 | | |
| 300 mm long | | | 10 | 1378160000 | | |
| | ADP 4 | 10 | 1378160000 | | | |
| | TSK 31.5 | 1 | 0347960000 | HP 7 | 20 | 0258260000 |

Several German VDE standards, e.g. VDE 0106 part 100 (March 1983), specify that mains terminals must be covered. Weidmüller can supply a range of such covers printed with a warning "lightning flash" and the international warning symbol. The other side features a "lightning flash" symbol with the warning "Danger! Electricity". Plastic screws are used to fix the cover plates to the terminal strips. The cover plates are intended for 3- or 4-pole terminals. Type BSK plastic screws are used to fix the plates. BSK = PA 66

AD/WAD covers



AD 3 (3-pole)

| Terminal type | Terminal width (mm) | Qty. | Order No. | Screw | Qty. | Order No. |
|---------------------|---------------------|------|------------|------------|------|------------|
| SAK 2.5 | 6 | 50 | 0297900000 | M 3 x 22 | 100 | 0128900000 |
| AKZ 4 | 6 | 50 | 0297900000 | M 2.5 x 18 | 100 | 0303300000 |
| DK 4 Q | 6 | 50 | 0297900000 | M 2.5 x 18 | 100 | 0303300000 |
| SAK 4 | 6.5 | 50 | 0297600000 | M 3 x 22 | 100 | 0128900000 |
| SAK 6 N | 8 | 50 | 0297700000 | M 3 x 22 | 100 | 0128900000 |
| SAK 10 | 10 | 50 | 0178500000 | M 3 x 22 | 100 | 0128900000 |
| SAK 16 | 12 | 50 | 0297800000 | M 3 x 22 | 100 | 0128900000 |
| SAK 35 N | 18 | 50 | 0273400000 | M 4 x 32 | 100 | 0129100000 |
| SAK 70 | 22 | 10 | 0344300000 | M 5 x 45 | 50 | 0344400000 |
| Screw for lead seal | | | | M 3 x 20 | 100 | 0451300000 |

AD 3 (4-pole)

| | | | | | | |
|---------------------|-----|----|------------|------------|-----|------------|
| SAK 2.5 | 6 | 50 | 0303400000 | M 3 x 22 | 100 | 0128900000 |
| AKZ 4 | 6 | 50 | 0303400000 | M 2.5 x 18 | 100 | 0303300000 |
| DK 4 Q | 6 | 50 | 0303400000 | M 2.5 x 18 | 100 | 0303300000 |
| SAK 4 | 6.5 | 50 | 0285300000 | M 3 x 22 | 100 | 0128900000 |
| SAK 6 N | 8 | 50 | 0196600000 | M 3 x 22 | 100 | 0128900000 |
| SAK 10 | 10 | 50 | 0178600000 | M 3 x 22 | 100 | 0128900000 |
| SAK 16 | 12 | 50 | 0518200000 | M 3 x 22 | 100 | 0128900000 |
| SAK 35 | 18 | 50 | 0178700000 | M 4 x 32 | 100 | 0129100000 |
| SAK 35 N | 16 | 50 | 0576700000 | M 4 x 32 | 100 | 0129100000 |
| Screw for lead seal | | | | M 3 x 20 | 100 | 0451300000 |

TBS 2 / BST 2

for the SAK series

Protective covers

Details

- For covering uninsulated cross-connections on
- Identification of functional groups.
- Insulating plate is inserted into the terminal.
- Labeling strips are clipped into the insulating plates.
- Permanent labelling or marking strip with temporary labelling



| Type | Order No. |
|-------------------------------------|------------|
| Type | |
| TBS 2, polyamide | |
| BST 2, unplasticised PVC | |
| Ordering data | |
| Type | |
| TBS insulating plate | 1287860000 |
| BST 2 labelling strip (300 mm long) | 1287700000 |

AD

for SAKG

Cover plates

These can be assembled either with two end clamp plates or with one end clamp plate and one partition plate plus mounting bracket.

Cover plates with self-adhesive label

Dimensions of cover plates

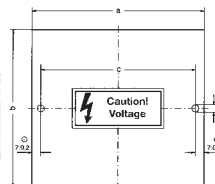
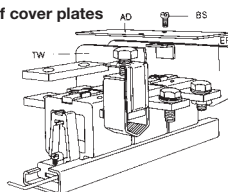

2 mm thick

| Type | Type | a | b | c | Order No. |
|--------------------|------|-----|-----|-----|------------|
| for SAKG 28 | AD 3 | 89 | 120 | 74 | – |
| for SAKG 28 | AD 4 | 116 | 120 | 102 | 0263100000 |
| for SAKG 32 and 70 | AD 4 | 132 | 120 | 118 | 0283100000 |
| for SAKG 40 | AD 3 | 124 | 160 | 110 | – |
| for SAKG 40 | AD 4 | 164 | 160 | 150 | 0263200000 |
| for SAKG 46 | AD 4 | 188 | 160 | 174 | 0263300000 |
| for SAKG 54 | AD 3 | 166 | 160 | 152 | 0264900000 |
| for SAKG 54 | AD 4 | 220 | 160 | 206 | 0261100000 |

AH

for SAKG

Shrouding covers

For open-type terminals like type SAKG. Shrouding covers are used – instead of other cover types – to provide the necessary protection against contact (required by German standard VBG 4). Shrouding covers are simply placed over the terminals.

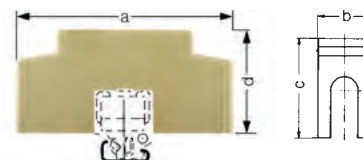

| Type | a | b | c | d | Order No. | |
|-------------------------|-------|-----|----|----|-----------|------------|
| dimensions in mm | | | | | | |
| for SAKG 28 | AH 28 | 156 | 26 | 74 | 94 | 0326660000 |
| for SAKG 32/70 | AH 32 | 156 | 30 | 74 | 94 | 0326760000 |
| for SAKG 40 | AH 40 | 186 | 38 | 78 | 94 | 0326860000 |
| for SAKG 46 | AH 46 | 196 | 46 | 78 | 94 | 0326960000 |

Protective covers

Cover strips for terminal strips

To protect against contact, dust and moisture, Weidmüller can supply cover strips which, for example, are useful in signal or lighting mast distribution boards.

Weidmüller can supply fully assembled and labelled terminal strips to meet your specification.

ADL

The ADL cover can be clipped to a TS 32 terminal rail.

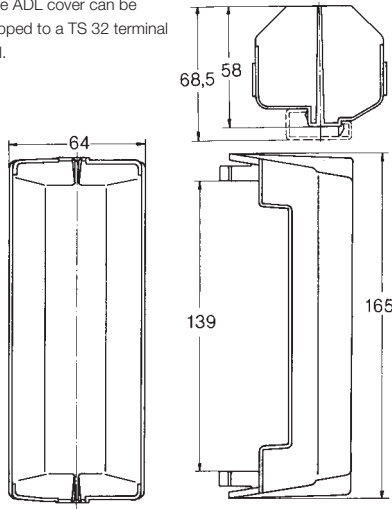

A selection of terminal types that can be fitted below this cover strip:

| TS 32 | |
|--------------------------------------|--|
| SAKD 2.5 N ... SAK 10 | |
| EK 2.5 N ... EK 10 | |
| SAKR, ASK 1, SAKT 1, SAKT 4, SAKB 10 | |
| SAKS 1, SAKS 3 | |

| Type | Qty. | Order No. |
|------|------|------------|
| ADL | 2 | 0210800000 |

AD 250

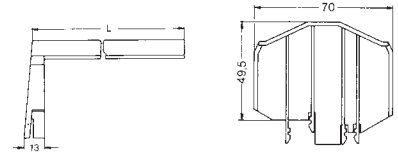

HP

retaining plate suitable for TS 32 and TS 35 x 7.5

height for TS 32: 64.5 mm

height for TS 35 x 7.5: 63 mm

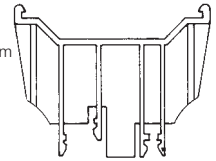

A selection of terminal types that can be fitted below this cover strip:

| TS 32 | | TS 35 | |
|------------------------------|--|----------------------|--|
| SAKD 2.5 N ... SAK 10 | | WDU 2.5 to WDU 10 | |
| EK 2.5 ... EK 10 | | WPE 2.5 to WPE 10 | |
| SAKR, ASK 1, SAKT 1, SAKB 10 | | WNT 2.5 to WNT 10 | |
| SAKS 1, SAKS 3 | | ASK 1, | |
| | | SAKS 1/35, SAKS 3/35 | |

| Type | Qty. | Order No. |
|--------------------|------|------------|
| AD 250 L = 250 mm | 1 | 0634100000 |
| HP EK1 32/2 AD 250 | 1 | 0634300000 |

Accessories for modular disconnect test terminals



QVS... cross-connection sliders

VH 19 connecting sleeves and BS 25 fixing screws (or StB 35 sockets) are required for fixing the QVS cross-connections to the individual terminals.

The fixing screws include an insulating sleeve for colour coding purposes and a guide for the screwdriver. The cross-connection sliders are designed so that the test plug sockets in the terminals remain accessible in every position.

The type QVS 2S 2-pole version is designed so that it can be slid even when a test plug has been inserted. If a test option is required when a QVS has been fitted, the fixing is best achieved with the StB 35 socket.

The clearance and creepage values required for the rated voltage of the terminal change when accessories are fitted.

StB sockets are screwed into the busbar for the modular terminals. They are used to accommodate PS 4 test plugs or QS 2 plug-in cross-connectors.

QVSK 2 (167036)

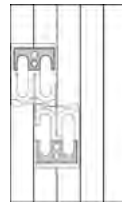

SAKT 2, SAKT 1

QVS 2 (030730)

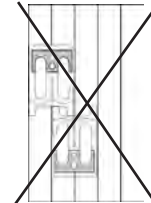

SAKT 1

Note:
QVS 2 units cannot be switched when installed like this.

Rated voltages

| for adjacent | rated voltage |
|--------------|---------------|
| QVS | 63 V |
| QL | 250 V |

| for adjacent | rated voltage |
|--------------|---------------|
| StB 25 | 63 V |
| StB 35 | 63 V |

TW partition plates or TSch insulating plates must be used to maintain the rated voltage.

The **SSP 3** and **SSP 4** prevent the unintended making or breaking of circuits. They lock the disconnection slider in its respective position. The lockout device can be easily pressed from above into the terminal and is then only removable with a tool.

| Type | Qty. | Order No. |
|-------|------|------------|
| SSP 3 | 100 | 0531760000 |
| SSP 4 | 20 | 1319360000 |

STB

Cross-connection sliders



QVS QVS QVSK 2 QVS 2S

STB

Sockets



| Type | No. of poles | Qty. | Order No. |
|--------|--------------|------|------------|
| QVS 2 | 2 poles | 20 | 0307300000 |
| QVSK 2 | 2 poles | 20 | 1670360000 |
| QVS 3 | 3 poles | 20 | 0329300000 |
| QVS 4 | 4 poles | 20 | 0307400000 |
| QVS 2S | 2 poles | 20 | 0358460000 |

| Type | Colour | Qty. | Order No. |
|-----------------|--------|------|------------|
| STB 14 | | | |
| STB 14 | | 50 | 0169900000 |
| STB 25 | | | |
| STB 25 | yellow | 50 | 0267200000 |
| STB 25 | green | 50 | 0271200000 |
| STB 25 | violet | 50 | 0271300000 |
| STB 25 | black | 50 | 0271500000 |
| STB 25 | grey | 50 | 0271400000 |
| STB 25 | blue | 50 | 0343400000 |
| STB 25 | red | 50 | 0343300000 |
| STB 30,5 | | | |
| STB 30,5 | yellow | 50 | 0341500000 |
| STB 30,5 | green | 50 | 0341400000 |
| STB 30,5 | violet | 50 | 0341600000 |
| STB 30,5 | black | 50 | 0341000000 |
| STB 30,5 | grey | 50 | 0341100000 |
| STB 30,5 | blue | 50 | 0341200000 |
| STB 30,5 | red | 50 | 0341300000 |
| STB 35 | | | |
| STB 35 | yellow | 50 | 0389000000 |
| STB 35 | green | 50 | 0388900000 |
| STB 35 | violet | 50 | 0389100000 |
| STB 35 | black | 50 | 0388500000 |
| STB 35 | grey | 50 | 0388600000 |
| STB 35 | blue | 50 | 0388700000 |
| STB 35 | red | 50 | 0388800000 |

BS fixing screws

VH connecting sleeves

QL cross-connections

The QL cross-connections enable connections between adjacent modular terminals.

QL cross-connection links

QL cross-connection links are used as permanent, i.e. non-switchable, cross-connections on SAKT disconnect terminals. VH 12 connecting sleeves and BS M3 x 20 fixing screws (or StB 30.5 sockets) are required for fixing these in position. The clearance and creepage values required for the rated voltage of the terminal can change when accessories are fitted. This is especially true with cross-connections between neighbouring terminals with different potentials.

QB cross-connection comb

The QB can be inserted from above on the SAKT1/QT1 cross-connect/disconnect terminal.

The connection or disconnection is then achieved by means of the integral disconnection slider.

QS 2 plug-in cross-connection

For 4 mm dia. sockets, for up to 44 A.

BS / VH

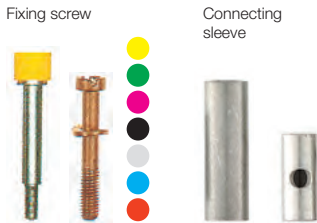

| Type | Colour | Qty. | Order No. |
|---------------------------|-------------|------|------------|
| Fixing screws | | | |
| BS 25 | yellow | 50 | 0335700000 |
| BS 25 | green | 50 | 0335600000 |
| BS 25 | violet | 50 | 0335800000 |
| BS 25 | black | 50 | 0335200000 |
| BS 25 | grey | 50 | 0335300000 |
| BS 25 | blue | 50 | 0335400000 |
| BS 25 | red | 50 | 0335500000 |
| BS 25 | uninsulated | 50 | 0334700000 |
| BS M 3 x 20 | | 100 | 0377100000 |
| CuNi 60 (copper alloy) | | | |
| Connecting sleeves | | | |
| VH 12 | | 100 | 0249000000 |
| E-Cu 57 (copper alloy) | | | |
| VH 19 | | 50 | 0318000000 |
| CuZn 39 (brass alloy) | | | |

QL / Q

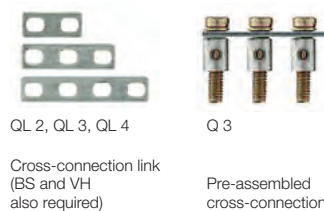

| Type | No. of poles | Qty. | Order No. |
|---------------------------|--------------|------|------------|
| QL 2, QL 3, QL 4 | | | |
| QL 2 | 2 poles | 50 | 0194300000 |
| QL 3 | 3 poles | 50 | 0194400000 |
| QL 4 | 4 poles | 50 | 0194500000 |
| QL 5 | 5 poles | 50 | 0220500000 |
| QL 6 | 6 poles | 50 | 0220600000 |
| QL 10 | 10 poles | 20 | 0338300000 |
| QL 15 | 15 poles | 10 | 0221200000 |
| E-Cu 57 (copper alloy) | | | |
| Q2 | 2 poles | 50 | 0456700000 |
| Q3 | 3 poles | 50 | 0456800000 |
| Q4 | 4 poles | 50 | 0456900000 |
| Q10 | 10 poles | 20 | 0457000000 |

QB



| Type | No. of poles | Qty. | Order No. |
|------------------|--------------|------|------------|
| QB 2, QB 3, QB 4 | | | |
| QB 2 | 2 poles | 50 | 0205700000 |
| QB 3 | 3 poles | 50 | 0205800000 |
| QB 4 | 4 poles | 50 | 0205900000 |
| QB 10 | 10 poles | 20 | 0343800000 |

QS 2

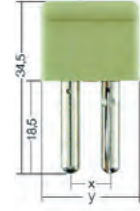

| Type | No. of poles | Qty. | Order No. |
|----------------------|--------------|------|------------|
| QS 2 | 2 poles | 20 | 0270960000 |
| x = 8 mm, y = 16 mm | | | |
| QS 2 | 2 poles | 20 | 0270860000 |
| x = 10 mm, y = 20 mm | | | |
| QS 2 | 2 poles | 20 | 0270760000 |
| x = 12 mm, y = 20 mm | | | |